



THUNDER-SCOUT

QUICK START GUIDE

A HERITAGE OF INNOVATION

You put your blood, sweat and tears into everything you do. Elgin products are made with that mantra in mind and more importantly, they are made for you.

We create tools that amplify the output of the everyday craftsman—the unapologetic, under-appreciated working class responsible for laying the brick & mortar of America. We believe there is no audience more inspiring or deserving to serve than this one, and it's our responsibility to enhance their workday with thoughtfully crafted products that combine cutting-edge tech with rugged & familiar designs.

Thank you for using the Elgin Thunder-Scout Headlamp.

Team Elgin



WHATS IN THE BOX

Thunder-Scout LED Headlamp

Three AAA Batteries
(Pre-Installed)



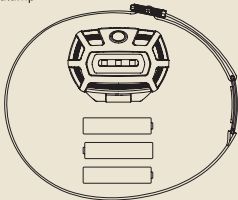

Headband

User Guide

Warranty Card



SPECIFICATIONS

FL 1 STANDARD	LOW	MEDIUM	HIGH	RED
 OUTPUT	6 LUMENS	20 LUMENS	200 LUMENS	20 LUMENS
 RUNTIME	60h	24h	6h	20h
 DISTANCE	<1m	6m	21m	4m
 INTENSITY	<1 CD	8 CD	108 CD	4 CD

INGRESS PROTECTION RATING

Your Elgin Thunder-Scout features an IP66 rated enclosure that protects against dust, sweat and water. The Thunder-Scout is not designed for prolonged submersion in water. In case of submersion in water, quickly remove from water and air dry before use.



USING THE
THUNDER-SCOUT

ACTIVATING THE LED LIGHT

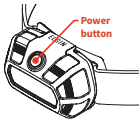

Press the power button once to activate the light. Repeat pressing the power button to cycle through each of the three brightness levels, red mode and to deactivate the headlamp.

HEADBAND ADJUSTMENT

Move the adjustment slider on the headband to customize the fit.

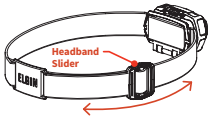

REPLACE BATTERIES

Tilt the headlamp forward on the angle adjustment hinge.

Lift up on the notched tab and open the battery compartment.

Remove old batteries and dispose of them according to local law.

Insert three new batteries and close the battery compartment.

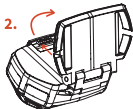
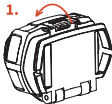

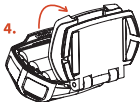
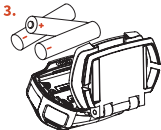

WARNING:

Do not mix rechargeable and non-rechargeable batteries.

Do not mix batteries of different types/brands.

Do not mix old and new batteries.

CARE AND MAINTENANCE

To clean the Thunder-Scout, use a damp cloth with or without mild soap to gently wipe away dust and dirt. Never use harsh or abrasive cloths or cleaners.

CONTACTING US

For questions or information regarding the Elgin Thunder-Scout or our other products, please contact us at support@elginusa.com or visit ElginUSA.com.



PARTS & ACCESSORIES

Genuine Elgin USA parts and accessories are available at ElginUSA.com/elgin-parts-accessories or simply scan the following QR code:

