



# REBEL

QUICK START GUIDE

## INCLUDED WITH YOUR ELGIN REBEL



Two pair of USP Class V  
Silicone Ear Tips  
(Small and Large)



Two pair of HD Foam  
Ear Tips  
(Small and Large)



Two Pair of Comfort  
Ear Tips  
(Small and Large)



Three pair of Ear Hooks  
(Small, Medium and Large)



USB-A to USB-C  
Charging Cable

## CONTACTING US

For questions or information about the Elgin Rebel or other products, please contact us at [support@elginusa.com](mailto:support@elginusa.com) or visit [ElginUSA.com](http://ElginUSA.com).

## REPLACEMENT EAR TIPS

Depending on your work environment, we recommend replacing your ear tips every 1 to 2 months to ensure optimum hearing protection and hygiene. To order additional ear tips, scan the QR code to the right with your smart phone or visit [ElginUSA.com](http://ElginUSA.com).



## **SAFETY INFORMATION**

Do NOT use in environments where you must be fully aware of their surroundings for personal or workplace safety reasons.

Do NOT use or charge this device in an explosive environment.

Misuse or failure to wear hearing protection at all times that you are exposed to loud noise may result in hearing loss or injury.

If the Elgin Rebel is connected to a device with a high audio output, it is the user's responsibility to set the device's audio output to a safe level.

Always ensure hearing protection is properly fitted.

Inspect the ear tips before each use for wear or damage. Ear tip integrity is vital for proper hearing protection. Replace worn or damaged ear tips before using your Elgin earbuds for hearing protection.

Although hearing protection can be recommended for protection against harmful effects of impulse noise, the Noise Reduction Rating of this device is based on the attenuation of continuous noise and may not be an accurate indicator of the protection attainable against impulse noise such as gunfire.

## CHARGING THE REBEL

The Rebel is partially charged out of the box; however, we recommend charging it fully before first use.

**ATTENTION: Only use the supplied USB-C cable.**

To charge the case, connect the provided USB-C charging cable to the charging port located on the side of the charging case.

The charging case LED indicator will turn red while the Rebel is charging. Once charging is complete, the LED indicator will turn green.

Approximate charge time is 2 hours. Once fully charged, the charging case can charge the earbuds approximately 5 times.

## CHARGING CASE BATTERY LEVEL INDICATOR

Press and hold the button on the charging case for 2 seconds to illuminate the charging case battery level indicator. The LED indicator will turn on for 3 seconds, indicating the battery level.

- ☀ Flashing Red - Battery level below 10%
- Red - Battery level below 20%
- Yellow - Battery level between 20% and 80%
- Green - Battery level above 80%

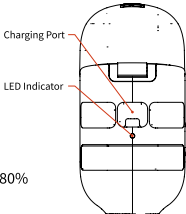

## CHARGING THE EARBUDS

To charge the earbuds, place each one in the charging case. The approximate charge time when the battery is at 0% is 2 hours.

### **Quick Charge Feature**

Charging the earbuds for 5 minutes will equal 1 hour of playtime.

### **Low Battery Reminder**

While the earbud is outside of the case, there will be a “*Low Battery*” voice prompt when the earbud battery level reaches 10% remaining. The “*Low Battery*” voice prompt will occur again when the earbud battery level reaches 5% remaining. When the earbud battery level reaches 0% remaining, the earbud will shut down.



## EARBUD BATTERY LEVEL INDICATOR

The earbud battery level LED indicator light is located inside charging case between the two earbud pockets. The LED light will activate for 3 seconds to indicate the battery level of each earbud as it is placed in the case.

- Red - Low battery level (below 10%)
- Yellow - Moderate battery level (10% to 80%)
- Green - High battery level (above 80%)

LED Indicator



## **CUSTOMIZING THE FIT**

The Rebel includes two sizes of silicone and foam ear tips along with three sizes of ear hooks to ensure a tight, comfortable seal for optimum hearing protection and comfort.

### **Replacing Ear Tips**

To change the size or type of ear tip, gently twist and pull to remove the installed ear tip and replace with your preferred size.

### **Replacing Ear Hooks**

To change the size of the ear hooks, gently remove the installed ear hooks and replace with your preferred size. To ensure proper positioning, align the keyhole on the ear hook with the key on the earbud.

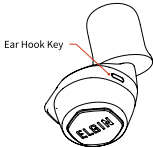

## Comfort Ear Tips

The Rebel also includes two sizes of black comfort ear tips. These are only intended for casual use when hearing protection is not required.

**WARNING: COMFORT EAR TIPS DO NOT PROVIDE ADEQUATE HEARING PROTECTION AND SHOULD NOT BE USED IN LOUD ENVIRONMENTS.**

## POWERING ON AND OFF

### **Automatic Power On**

The earbuds will automatically power on when they are removed from the charging case. There will be a “*Power On*” voice prompt.

### **Manual Power On**

When the earbuds are not in the case and in the off state, press and hold the multi-function button on each earbud for 2 seconds. There will be a “*Power On*” voice prompt.

### **Automatic Power Off**

The earbuds will automatically power off when they are placed into the charging case. There is a “*Power Off*” voice prompt.

The earbuds will automatically shut down if not successfully paired with a mobile device within 3 minutes. There will be a “*Power Off*” voice prompt.

If the earbuds are disconnected from the mobile device they will enter pairing mode. If not successfully re-paired with a mobile device within 3 minutes, the earbuds will automatically shut down. There will be a “*Power Off*” voice prompt.

When the earbuds are connected to a mobile device they will automatically shut down after 2 hours of inactivity.

## **BLUETOOTH® PAIRING**

Activate Bluetooth on your phone or Bluetooth enabled device and ensure it is actively scanning for available Bluetooth devices.

### **Pairing a Device for The First Time**

Remove the Rebel earbuds from the charging case. The earbuds will automatically enter pairing mode. Search the list of available devices on your phone or Bluetooth device and select **Elgin Rebel**. If the connection is successful, there will be a “*Connected*” voice prompt.

### **Using a Previously Paired Device**

When the Rebel earbuds are removed from the charging case, they will attempt to automatically connect to the most recently paired

Bluetooth device. If the connection is successful, there will be a “*Connected*” voice prompt.

If the earbuds have shut down outside of the charging case, manually turn on the earbuds by pressing and holding the multi-function button on each earbud for 2 seconds. The earbuds will enter pairing mode and attempt to automatically connect to the most recently paired device. If the connection is successful, there will be a “*Connected*” voice prompt.

Note: If pairing is unsuccessful, the earbuds will automatically shut down after 3 minutes.

# MAKING AND RECEIVING PHONE CALLS

## Answering Incoming Calls

Double-press the left or right multi-function button. There will be an audio prompt.

## Mute Microphone

While on a call, press the left or right multi-function button to turn off the microphone. Press the left or right multi-function button again to turn on the microphone. There will be a “*Mute On*” or “*Mute Off*” voice prompt.

## Ending a Call

Double-press the left or right multi-function button to end the call. There will be an audio prompt.



## **Reject Incoming Call**

When receiving an incoming call, Press and hold the left or right multi-function button for 2 seconds to reject the call. There will be an audio prompt.

## **Cancel Dialing**

While making a call, double-press the left or right multi-function button to cancel dialing. There will be an audio prompt.

## MAKING AND RECEIVING PHONE CALLS

### **Three-Way Calling**

While a call is in progress and a second call comes in, double-press the left/right multi-function button to answer the second call and place the first call on hold. There will be an audio prompt.

While a three-way call is in progress, double-press the left/right multi-function button to switch between calls. There will be an audio prompt.

While a three-way call is in progress, press and hold the multi-function button to end the current call and switch to the other call. There will be an audio prompt.

## **VIRTUAL ASSISTANT**

While the earbuds are connected to a device and in a stand-by mode or playing audio, press and hold the left or right multi-function button for 2 seconds to activate Siri® or Google Assistant™.

## **VOLUME CONTROL**

You may use your device's virtual assistant (Siri®/Google Assistant™) to adjust the volume of your Rebel earbuds. We recommend asking for specific volume percentages. For example, "Hey Siri. Set volume to 20 percent."

You may also use the manual volume controls on the connected device to adjustment volume.

## **AUDIO PLAYBACK**

### **Audio Play/Pause**

Single-press the left or right multi-function button to play/pause audio content.

### **Skip Forward**

Double-press the left or right multi-function button to skip to the next track.

### **Skip Backward**

Triple-press the left/right multi-function button to skip backward. If done after the first 3 seconds of a song, the song will restart. If completed within the first 3 seconds, the previous track will be played.

## INTEGRATED LED FLASHLIGHT

To activate the Rebel's integrated flashlight, short press the flashlight power button on the side of the case. Short press again to switch through each level of brightness (firefly, low, high) or to turn off.

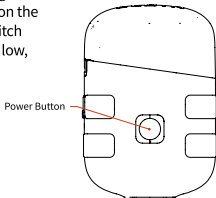
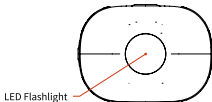

## LED FLASHLIGHT LEVELS

The integrated LED flashlight offers three modes of brightness: Firefly, Low, and High. The usage time of the flashlight depends on the active mode and is based on a fully charged case battery.

<b>Flashlight Mode</b>	<b>Lumens</b>	<b>Usage Time</b>
Firefly	0.5 Lumens	360 Hours
Low	50 Lumens	11 Hours
High	Starts at 100 lm for 3 minutes then decreases to 80 lm	4 Hours
Off	No Output	

## **ABNORMAL TEMPERATURE WARNING**

While charging, if the battery reaches an abnormal temperature, charging will cease and the case battery level indicator light will flash red. Remove from the charger and allow for the unit to cool down before attempting to charge again. If the problem persists, please contact customer service for assistance.

## **CLEARING THE PAIRING RECORD**

While the earbuds are on but not connected to a mobile device, press and hold the left/right multi-function button for 8 seconds. There will be an audio prompt to indicate the pairing record was successfully cleared.

# NOISE REDUCTION RATING

## SILICONE EAR TIPS - ATTENUATION DATA (ANSI S3.19-1974)

Test Frequency (Hz)	125	250	500	1000	2000	3150	4000	6300	8000	<b>NRR 25</b>
Mean Attenuation (dB)	19.0	19.5	19.0	31.5	31.0	31.0	45.0	48.5	43.0	
Standard Deviation	2.8	0.7	2.8	0.7	1.4	1.4	2.8	0.7	1.4	

## FOAM EAR TIPS - ATTENUATION DATA (ANSI S3.19-1974)

Test Frequency (Hz)	125	250	500	1000	2000	3150	4000	6300	8000	<b>NRR 25</b>
Mean Attenuation (dB)	21.5	18.5	24.0	25.0	29.5	30.0	49.0	48.5	43.5	
Standard Deviation	3.5	2.1	2.8	1.4	0.7	1.4	4.2	0.7	0.7	



The Environmental Protection Agency (EPA) has chosen the Noise Reduction Rating (NRR) as the measure of a hearing protection device's noise-reducing capabilities.

The NRR for the Elgin Rebel, calculated from laboratory-based attenuation data, is **25 decibels**. Improper fitting of this device will reduce its effectiveness in attenuating noise. Consult the instructions in this guide for proper fit.

**Example:** If the noise level of your environment measures 100 dB(A), the level of noise entering the ear upon using Elgin earphones is approximately equal to 75 dB(A).

## NOISE REDUCTION RATING (CONTINUED)

Elgin makes no warranties as to the suitability of the NRR as a measure of actual protection from any noise level since such protection depends on the sound level (loudness), how long you listen to the loud sound and how well you fit the earbuds in your ears.

Noise  
Reduction  
Rating

**25** Decibels  
(when used as directed)

THE RANGE OF NOISE REDUCTION RATINGS  
FOR EXISTING HEARING PROTECTORS  
IS APPROXIMATELY 0 TO 30  
(HIGHER NUMBERS DENOTE GREATER EFFECTIVENESS)

Elgin USA  
Fort Worth, TX

M4.1

Federal law prohibits  
removal of this label  
prior to purchase



LABEL REQUIRED BY  
U.S. E.P.A. REGULATIONS  
40 CFR PART 211, SUBPART B

## **INGRESS PROTECTION RATING**

Your Elgin earbuds feature an IP65 rated enclosure that protects against dust and water. Rebel earbuds are not designed for swimming, showering or submersion in water. In case of submersion in water, quickly remove from water and air dry before use.

## **CARE AND MAINTENANCE**

Keeping your Elgin earbuds clean is important for safe, hygienic use.

Clean the ear tips regularly of dirt and wax buildup. To clean, remove ear tips from earbuds, then gently wipe away dust and dirt with a dry cloth, and/or use warm water and mild soap. Never use harsh or abrasive cleaners on any part of your Elgin earbuds.

AMPLIFY YOUR  
OUTPUT

ELGIN